



**UNTERMAN McPHAIL ASSOCIATES**  
HERITAGE RESOURCE MANAGEMENT CONSULTANTS  
540 RUNNYMEDE ROAD  
TORONTO ONTARIO M6S 2Z7  
T 416 766 7333  
F 416 763 4082  
E [umcarubm@pathcom.com](mailto:umcarubm@pathcom.com)

## memorandum

**to:** MMM Group Limited  
**from:** Richard Unterman, MA Conservation Studies  
**date:** April 1, 2014  
**re:** Yonge Subway Extension – TSF Environmental Project Report Addendum  
Cultural Heritage Assessment Report

---

### Introduction

MMM Group (formerly McCormick Rankin Corporation) retained Unterman McPhail Associates, Heritage Management Resource Consultants, to undertake a cultural heritage resource survey and assessment of built heritage resources and cultural heritage landscapes for the proposed Train Storage Facility (TSF) in the vicinity of the Richmond Hill Centre, at the north end of the approved Yonge Subway Extension (YSE).

This Memorandum has been prepared to provide an overview of the cultural heritage resource survey, including existing conditions, potential impacts and recommendations.

### Project Description

The purpose of the YSE project is to extend the Yonge Subway from its current terminus at Finch Station in the City of Toronto to Highway 7 (Richmond Hill Centre) in the Town of Richmond Hill. The Toronto Transit Commission (TTC) reviewed the subway rail yard needs for the Yonge Subway to the year 2030. It was determined that the car fleet would grow from 62 trains to a total of 88 trains. This in turn, led to conclusions that a 14-car TSF should be built and a yard property should be purchased in the area of Richmond Hill Centre to accommodate the fleet growth beyond the year of 2030.

A Conceptual Design Study was completed by MMM Group, and Hatch Mott MacDonald in March 2012. Based on a detailed technical assessment, construction of a three-track structure extending north from the Richmond Hill Centre Station adjacent to the existing CN/GO rail was selected as the preferred alternative.

The study area for the cultural heritage resource survey included the area impacted by the proposed TSF, approximately 250m east of Yonge Street and directly below the existing High Tech road overpass and current Silver City theatre complex. A crossover will be located south of the station with tail tracks and a train storage facility located north of the station. An existing GO Transit rail station is located east of the CN Bala Subdivision rail line and is connected to the existing Viva/407 bus terminal on the west side by an overhead pedestrian bridge.

### **Approach**

Unterman McPhail Associates completed a windshield survey of the study area in March 2013 to identify potential cultural heritage resources that will be affected by the proposed infrastructure development.

### **Survey Results**

Based on the attached Ultimate Surface Facilities Plan, the project description and the review of the existing conditions it was concluded that no direct (demolition or removal) or indirect (disruption) impacts to built heritage and cultural heritage resources will occur from this undertaking.

### **Recommendations**

No recommendations to conserve or limit adverse impacts to cultural heritage resources are merited.

RU/UMcA

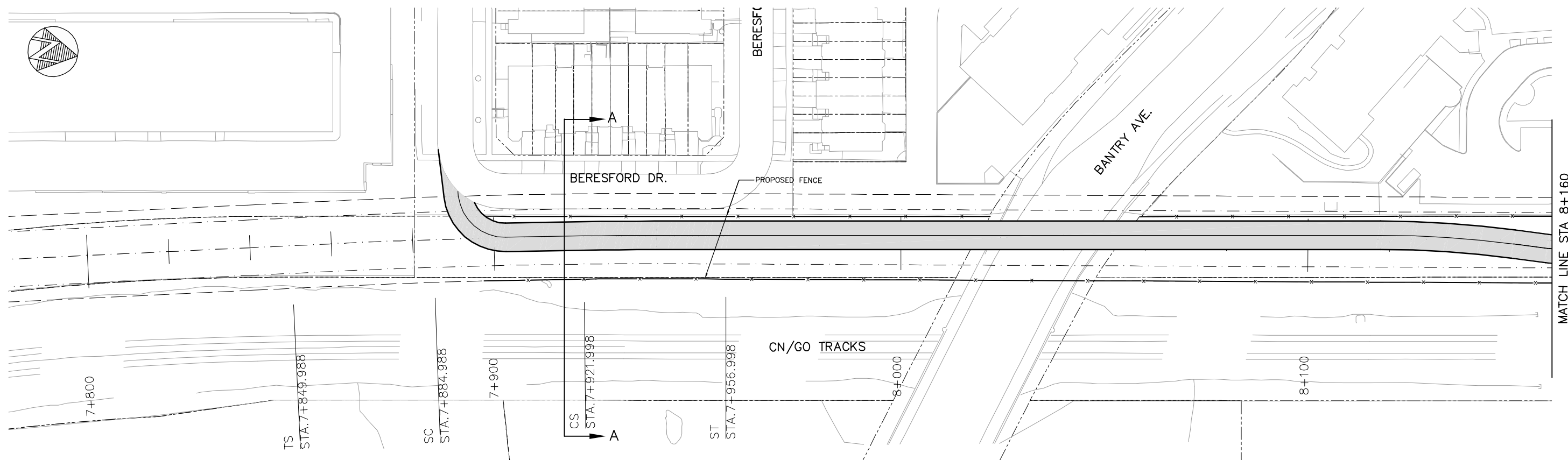

Attach.

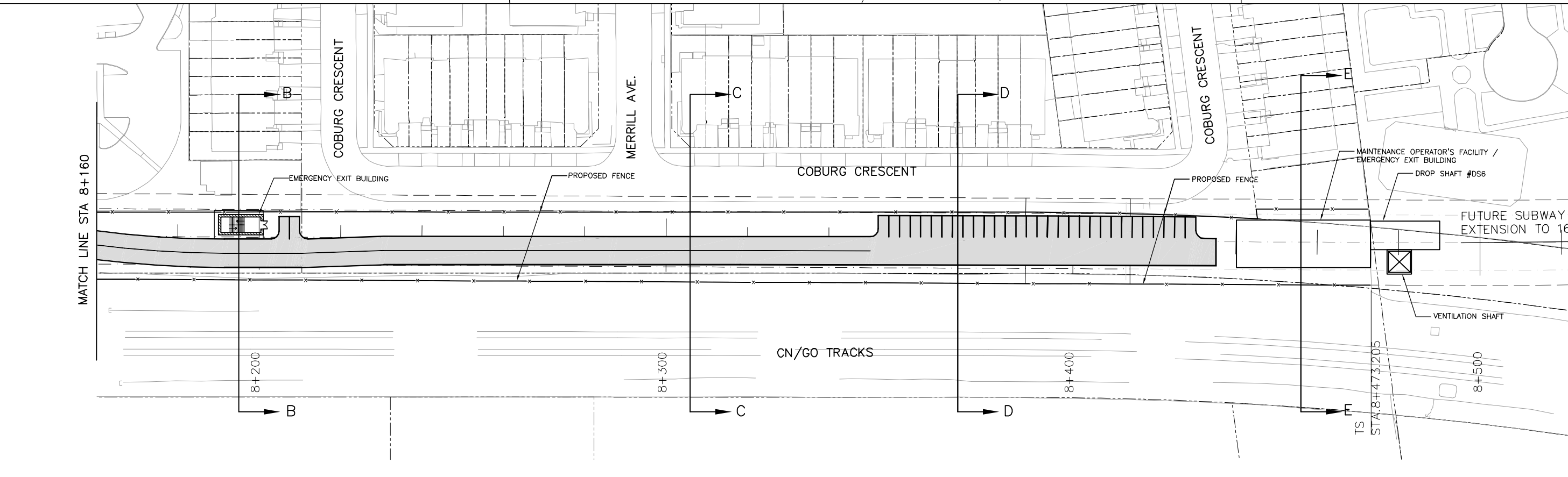

MATCH LINE STA 8+160



MATCH LINE STA 8+160

  	LEGEND:	DATE: JANUARY 2014	<b>YONGE SUBWAY EXTENSION ENVIRONMENTAL PROJECT REPORT ADDENDUM</b>	FIGURE
		SCALE: 1:1000		