

Town of Markham and Richmond Hill

- > The vivaNext rapidway will connect the emerging new downtowns that are planned for the centres of Markham and Richmond Hill
- > VivaNext will support each town as it grows into the future
- > Each town has its own growth strategies, urban design priorities and land use vision
- > We have taken care to work closely with Markham and Richmond Hill planners to respect their communities' objectives
- > The vivaNext rapidway will complement and enhance local land use and urban design priorities



Markham Centre



Richmond Hill Centre



part of a seamless region-wide transit network

- > The Highway 7 rapidways are part of the vivaNext plan to build a modern, efficient rapid transit network that connects York Region's urban centres and enriches our communities
- > The plan includes rapidways on Highway 7 in Richmond Hill and Markham as well as two subway extensions and two proposed light rail transit lines



VIVA
Viva Rapid Transit



GO
GO Transit

Brampton Transit

YORK REGION TRANSIT

Durham Region Transit

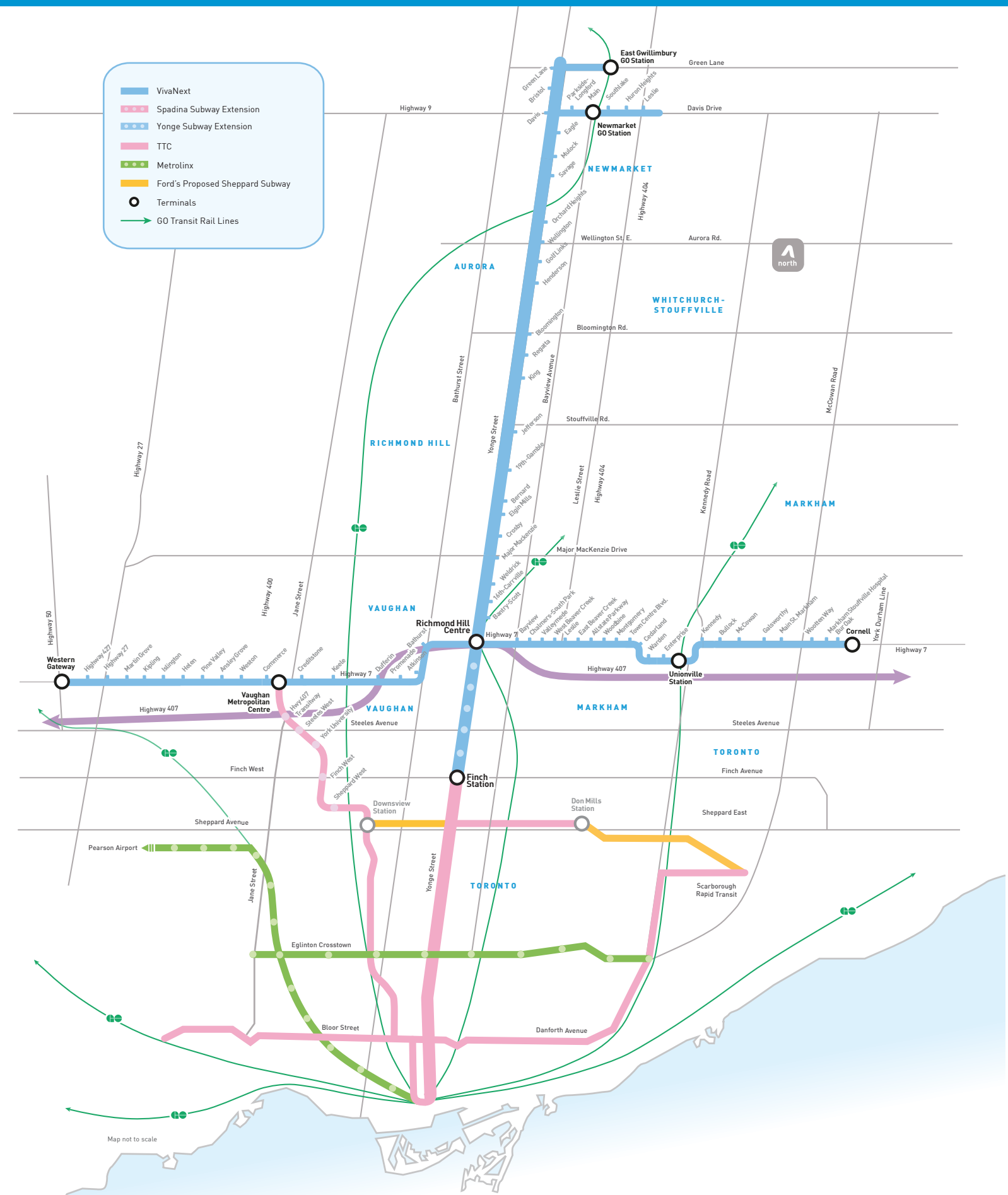

VIVAnext

relieving traffic congestion on highway 7



shaping development on highway 7

- > Improved transit access
 - Helps shape successful urban renewal along the route
 - Encourages building of attractive, pedestrian-friendly places for people to live, work, shop and play



highway 7 rapidways

1 bayview avenue to chalmers road



highway 7 rapidways

2 rockwell road to west beaver creek road



highway 7 rapidways

3 west beaver creek road to east beaver creek road

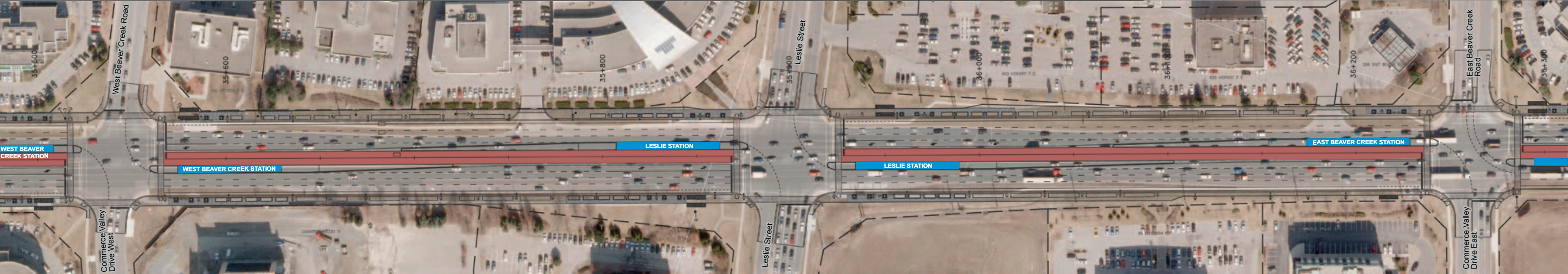

highway 7 rapidways

4 east beaver creek road to east of highway 404

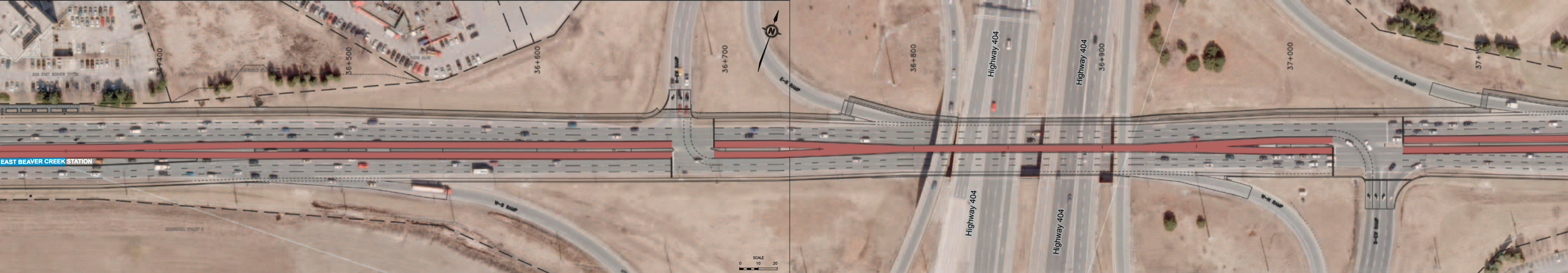

highway 7 rapidways

5 allstate parkway to woodbine avenue

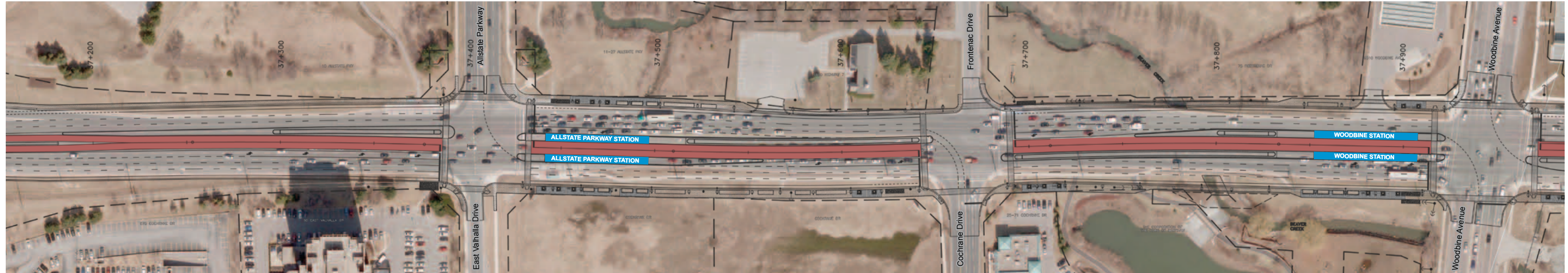

highway 7 rapidways

6 lunar crescent to east of montgomery court



highway 7 rapidways

7 rodick road to town centre boulevard

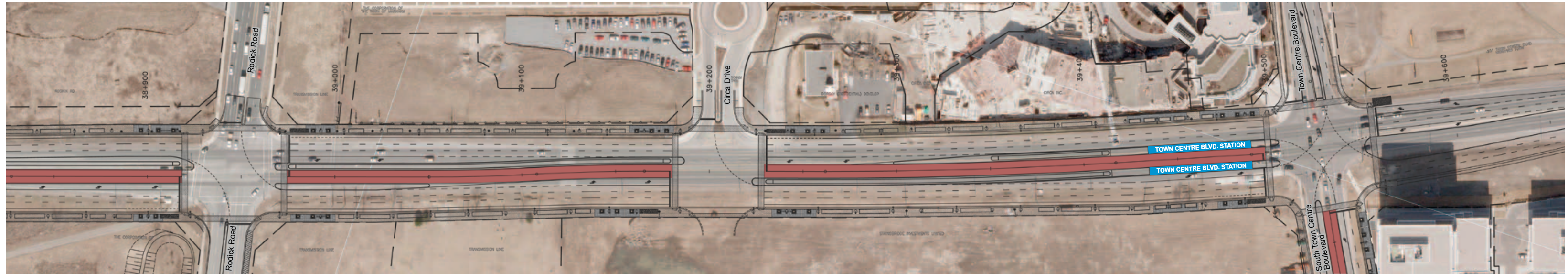

highway 7 rapidways

8 south town centre boulevard to enterprise drive



pedestrian-friendly intersections along highway 7

> No right turns will be permitted on red lights at signalized intersections along Highway 7

> This change will make it safer and easier for pedestrians to cross intersections and access vivastations located in centre lanes along rapidways

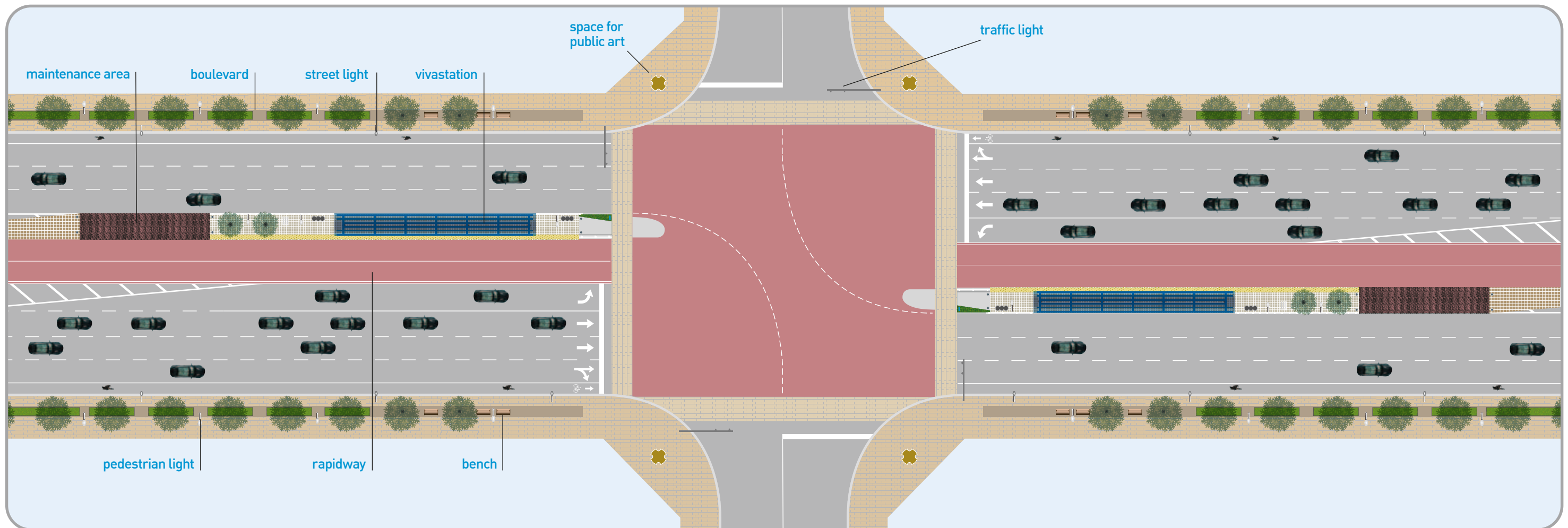

how traffic flow will operate at 4-way intersections

legend	
regular traffic	
viva	
pedestrians	
bicycles	

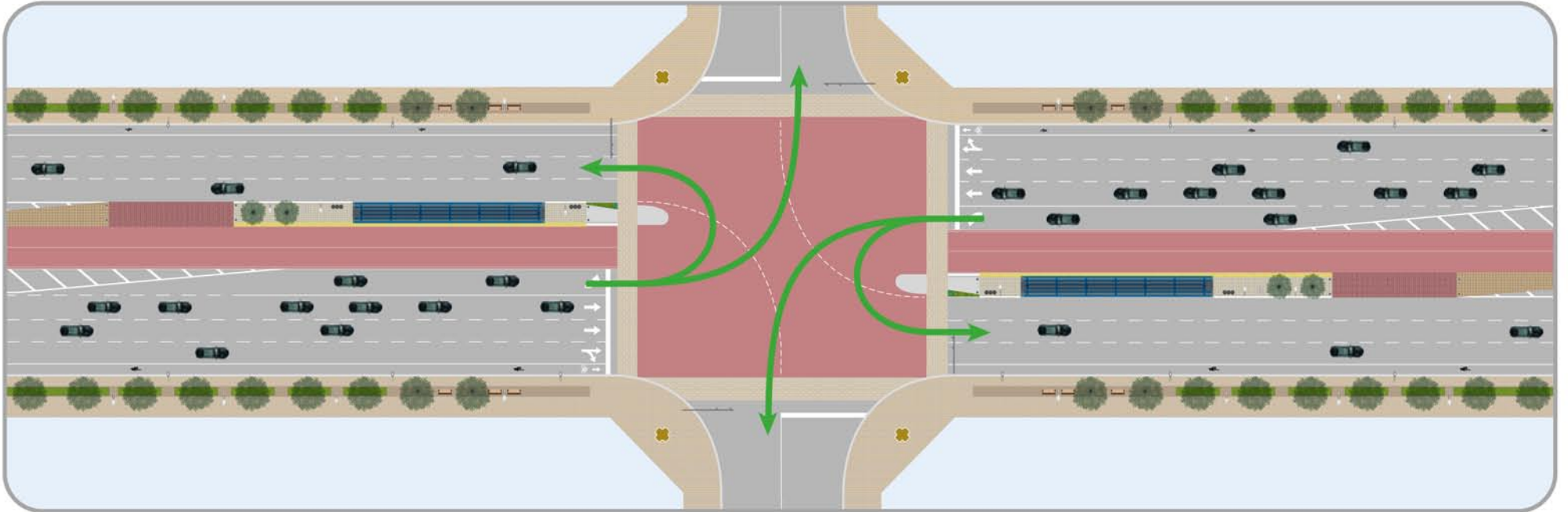

first signal phase: left and u-turns

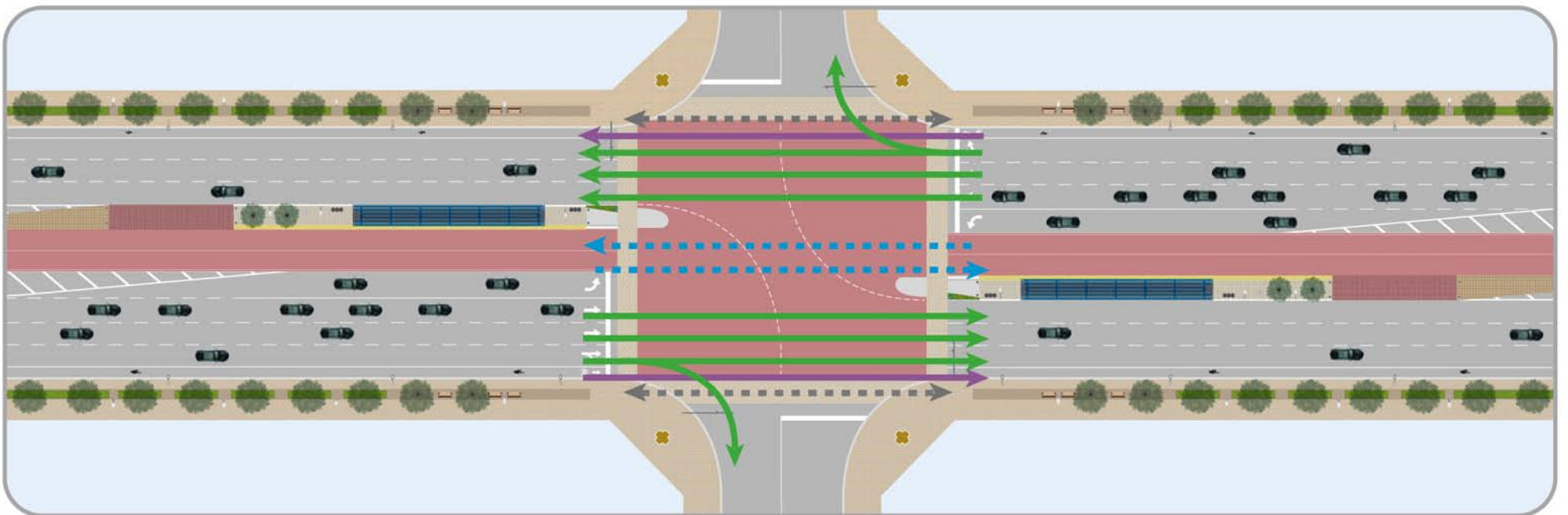

second signal phase: general traffic, pedestrians and viva rapid transit

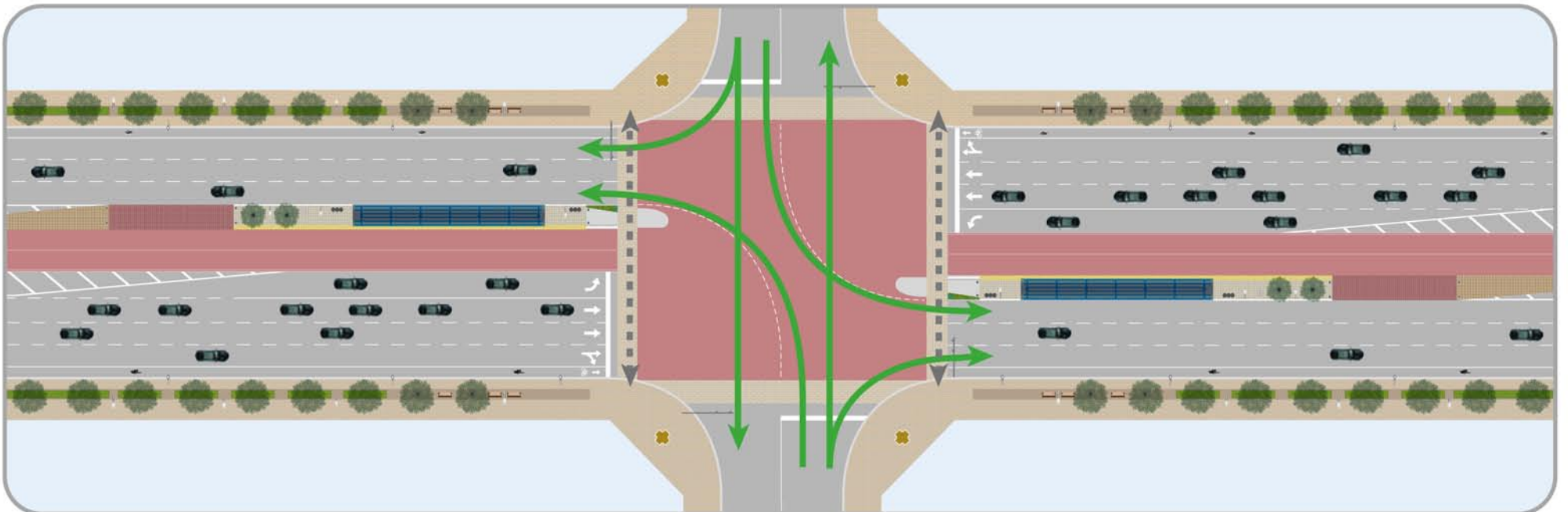

third signal phase: cross street general traffic and pedestrians

safer, more convenient left turns across highway 7

- > Improved mid-block access across Highway 7
- > Drivers will proceed to nearest signalized intersection and follow dedicated u-turn lights to safely and conveniently complete turns

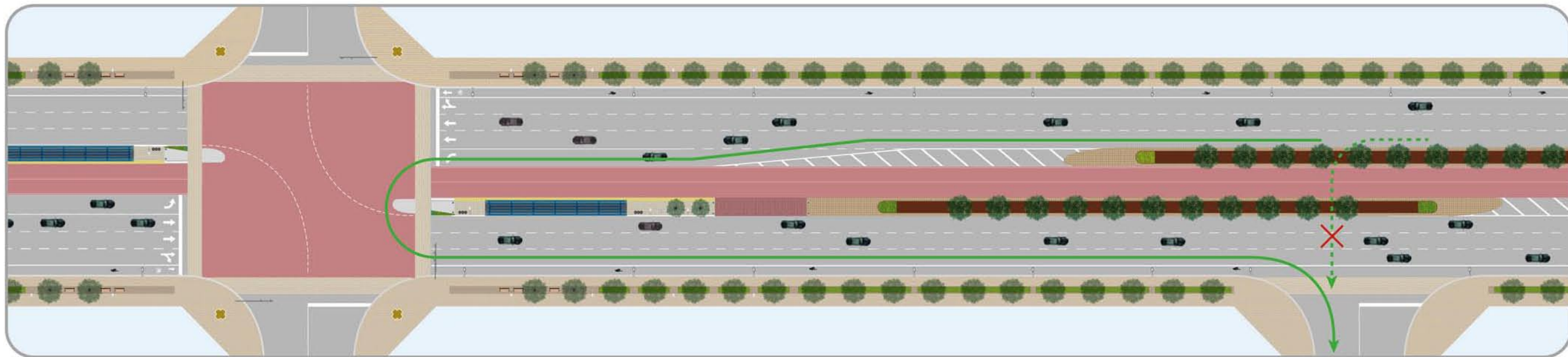

access to side streets

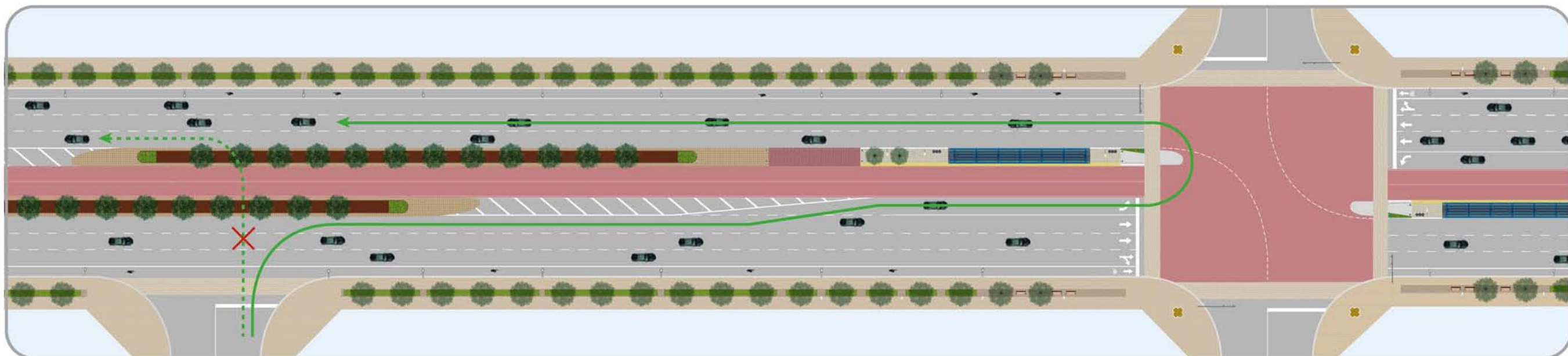

access from side streets

attractive, welcoming streetscapes

> Landscaped areas, comfortable seating, improved lighting, and attractive architectural elements will transform Highway 7 into a key destination for people to meet, gather and socialize

> The combination of great transit access and wider, pedestrian-friendly sidewalks will encourage businesses and developers to offer more choices to work, dine, relax, live and shop

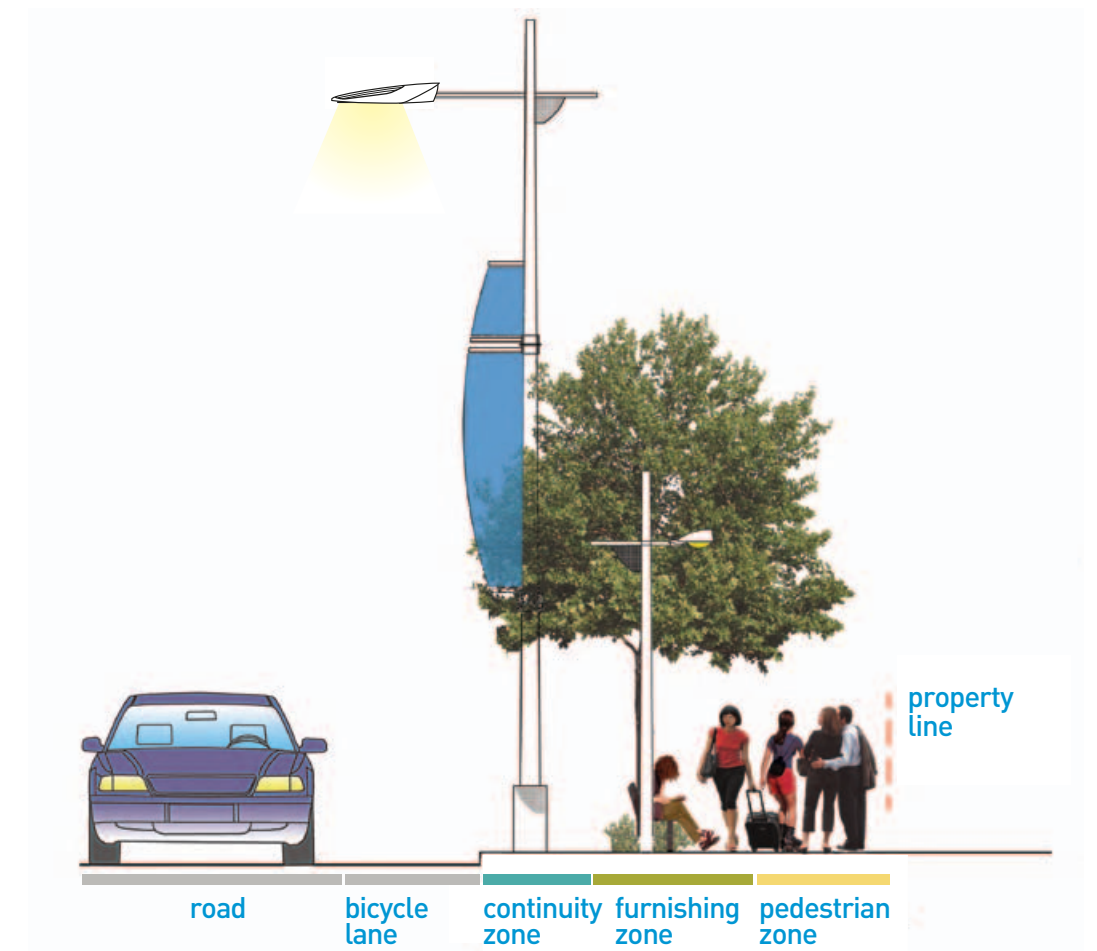
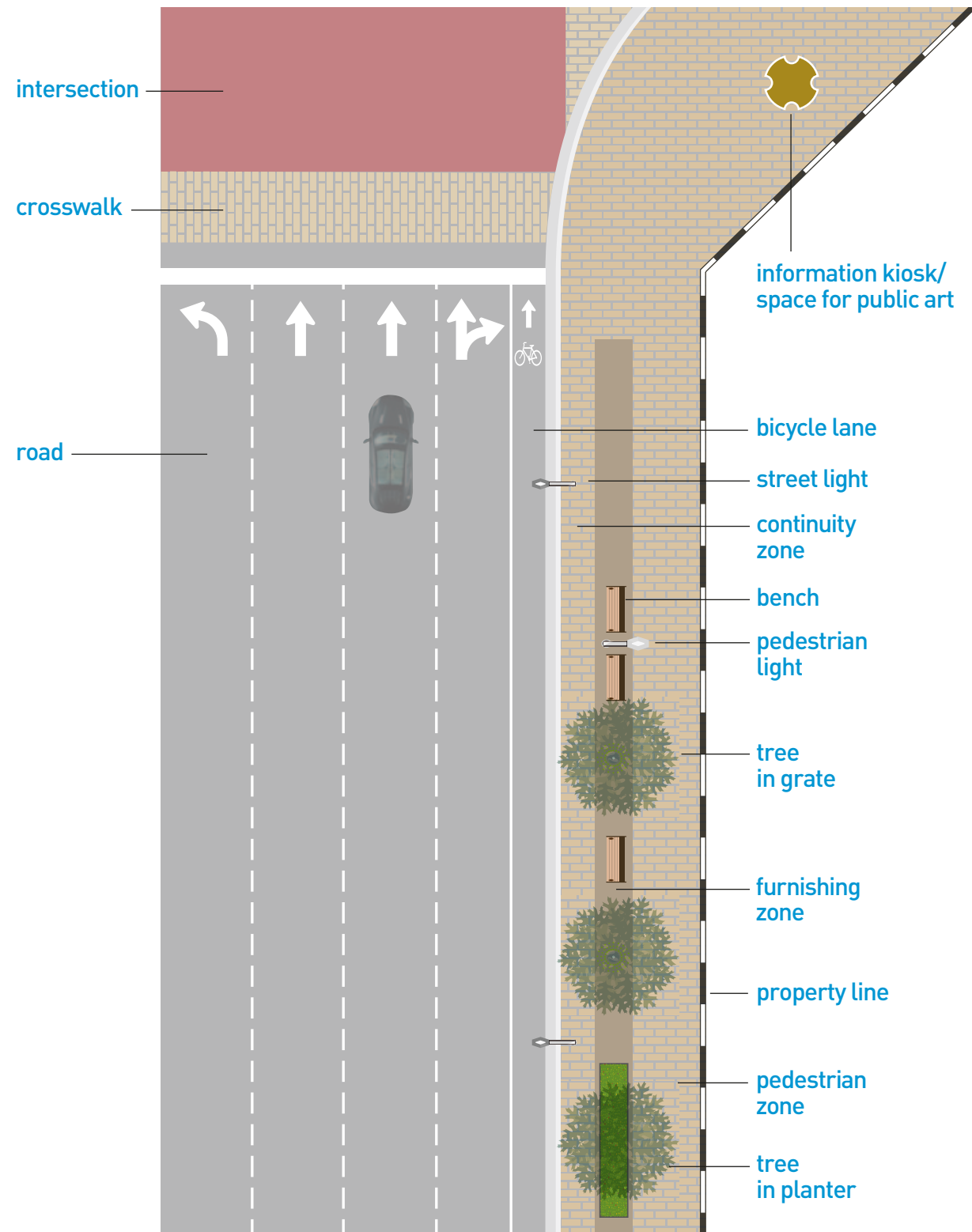

new vivastations will provide greater comfort and convenience

arrival/departure screens provide real-time scheduling info plus up-to-the-minute time, weather, news, sports and market headlines

roof extends up and over Viva vehicles to keep snow and rain off while embarking/d disembarking

extended platform length can accommodate multiple Viva vehicles, enhancing embarking/d disembarking efficiency

roof and side panels made of reflective tinted glass for greater visibility and comfort

raised platform provides level boarding of Viva vehicles, eliminating the need to climb steps or lift objects

full-time security surveillance and intercom for emergency assistance on platform

temperature and motion activated heaters in full wind enclosure provide warmth while motion-activated entry doors minimize heat loss

tactile pavers along rapidway edge provide greater safety



way finding signage provides riders with easy and quick direction



energy-efficient lighting throughout for greater safety and comfort



ample seating inside and out provides greater personal space and comfort



flexible cash, pass and Presto fare machines

environment and green, open spaces are priorities

- > Our project plans to mitigate any negative impacts to the environment and explores opportunities to increase green, open spaces
- > Key project legacy: up to 30% more trees to be planted along Highway 7



street tree selection



Red Oak



Pear



Shademaster Honeylocust



Ivory Silk Tree Lilac

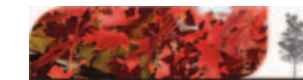

Freeman Maple



Field Maple



Greenspire Linden



Shubert Chokeberry



building a rapidway step-by-step

- > Every effort will be made to minimize the impacts of construction and ensure that traffic keeps moving as smoothly as possible. However, progress is dependent on a number of factors, including weather and scheduling; these factors may affect timing.



10. Line painting of roadways and crosswalks

9. Complete paving of roadways and rapidways

8. Install electrical work including VMS, TVM, lighting, and cameras

7. Build canopy foundations and canopy structure

6. Install permanent traffic signals

5. Landscape boulevards and install street lights

4. Construct new lane widenings

3. Remove existing curbs and gutters

2. Remove existing median and repave median

1. Relocate existing underground utilities and install temporary traffic signals

how construction will continue to unfold in 2011



- > Detail design work and some utility relocations got underway in 2010
- > Utility relocations will continue as well as temporary traffic signal installation
- > Main road construction of the rapidways will commence in Spring of 2011 and progress generally from the west side of the project [west of 404] to the east

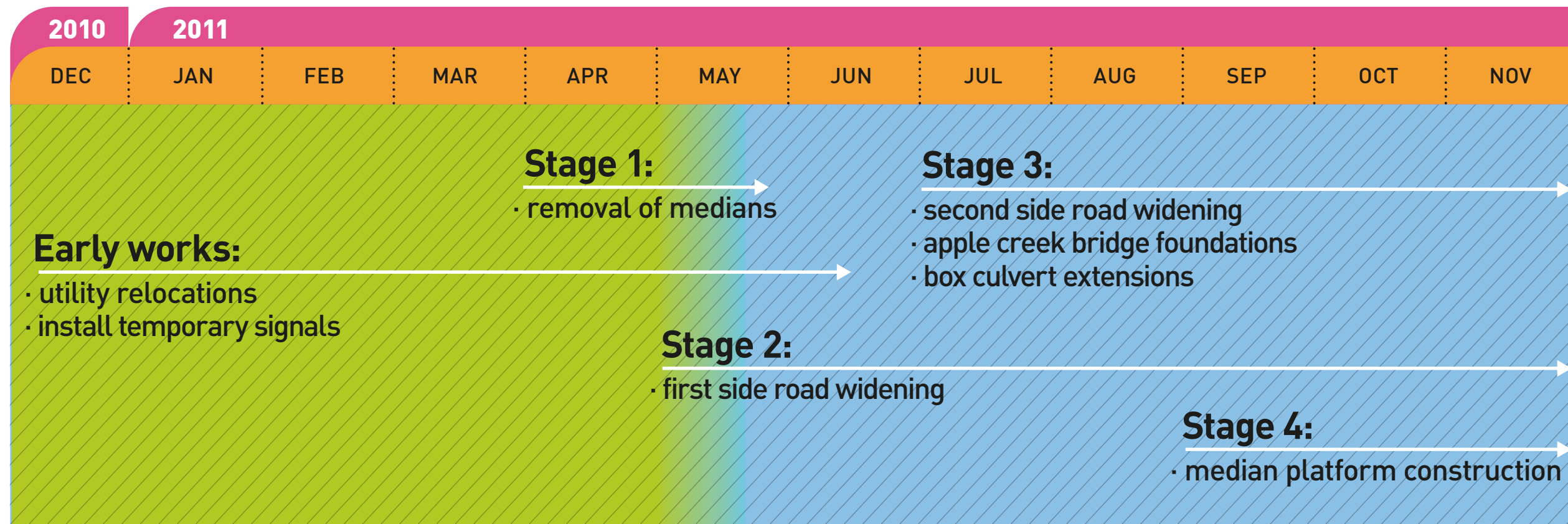

*Work schedule subject to change.

bayview station concept

- > Bayview station will be a curbside platform, unlike other median vivastations
 - The platform will be built after the road widening work is completed
 - Construction of the platform will commence in June 2011
 - A temporary Viva shelter will be put in place, however service will not change
- Temporary sidewalks will route pedestrians around the construction zone
- Pedestrian access to the staircase leading up to Bayview Ave. will also be maintained during construction



north tower



west and east elevation



south elevation

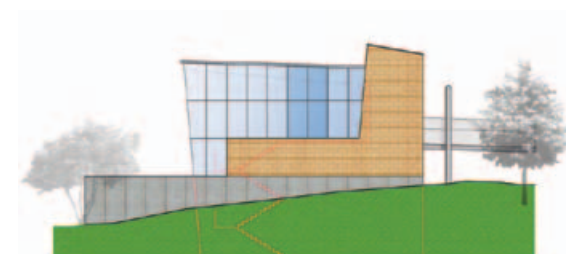

north elevation

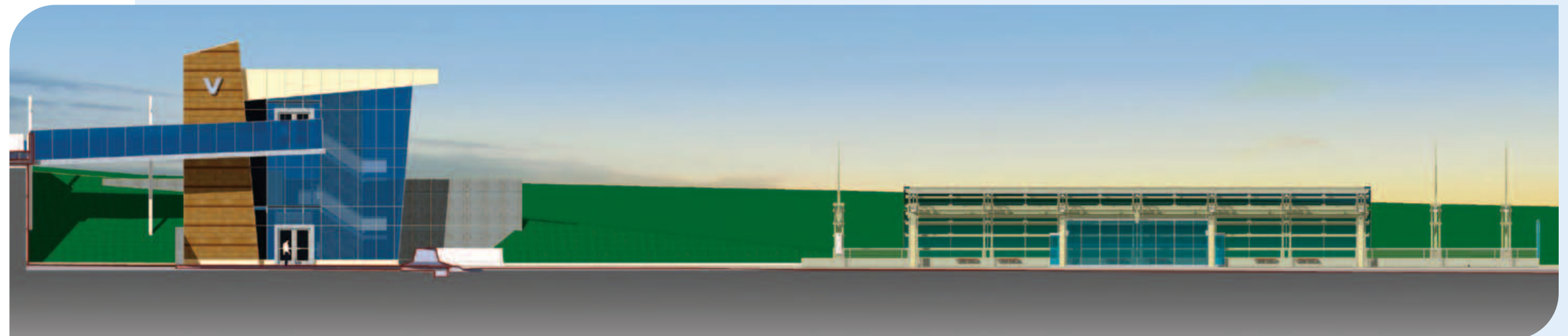

high level 3-year schedule

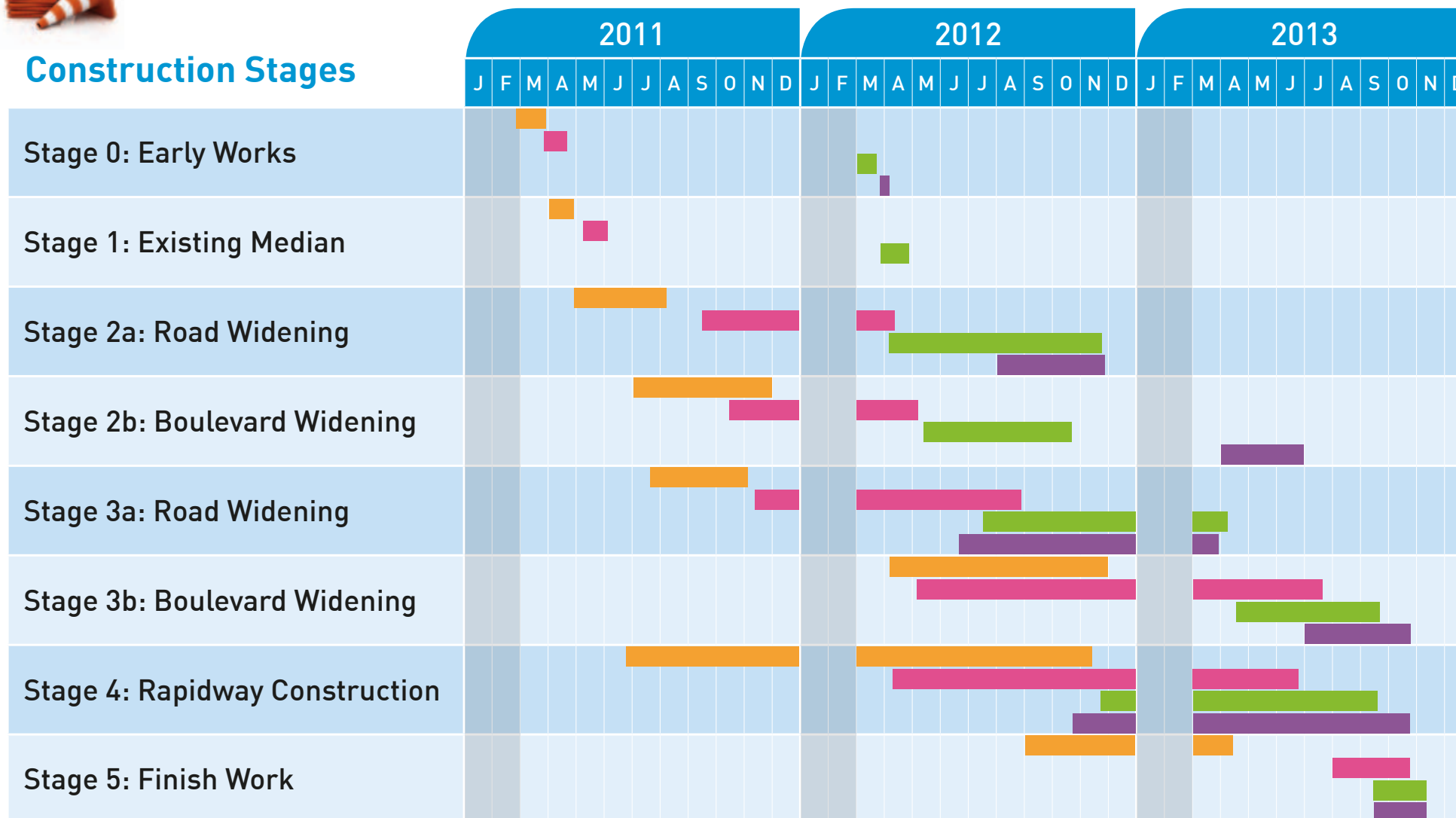

Legend

- Bayview Avenue to Highway 404
- Lunar Crescent to South Town Centre Boulevard
- Highway 404 to Lunar Crescent
- South Town Centre Boulevard to Enterprise Drive



safety during construction

- > Keeping drivers, pedestrians, cyclists and workers safe during construction is a top priority
- > York Region is currently reviewing the optimal future speed limit along Highway 7, for the construction phase and also for when the rapidway is completed



- > Cyclists may find it more convenient to use alternate routes during construction
- > We will provide clear, easy-to-understand signs so drivers and pedestrians are aware of alternate access points for businesses



access for pedestrians

- > Pedestrian convenience is a top priority
- > When sidewalks have to be temporarily re-routed, there will be clear signs showing pedestrians where to go
- > Signs and temporary sidewalks where needed will make it easy to locate and access your favourite stores and other businesses
- > If transit stops are temporarily relocated, signs will be posted describing the new location and the easiest way to get there



preparing site for main road construction

- > Early works construction is an important part of the process that prepares the work site for main road construction
 - Soil identified as contaminated during soil testing [i.e. around former gas stations] is removed and the area cleaned up
 - Utility lines located in the construction zone [i.e. phone, hydro, gas, cable] are relocated
 - Trees and shrubs are relocated and/or removed, with up to 30% more being replanted as part of the project



main road construction staged to minimize disruption

- > Main road construction will be staged. Work will take place on both the north and south side of Highway 7; however, not in the same area
- > Minimizes disruption to local community, transit users and drivers
- > Allows same number of existing traffic lanes to remain open during construction



Stage 1 Removal of centre medians

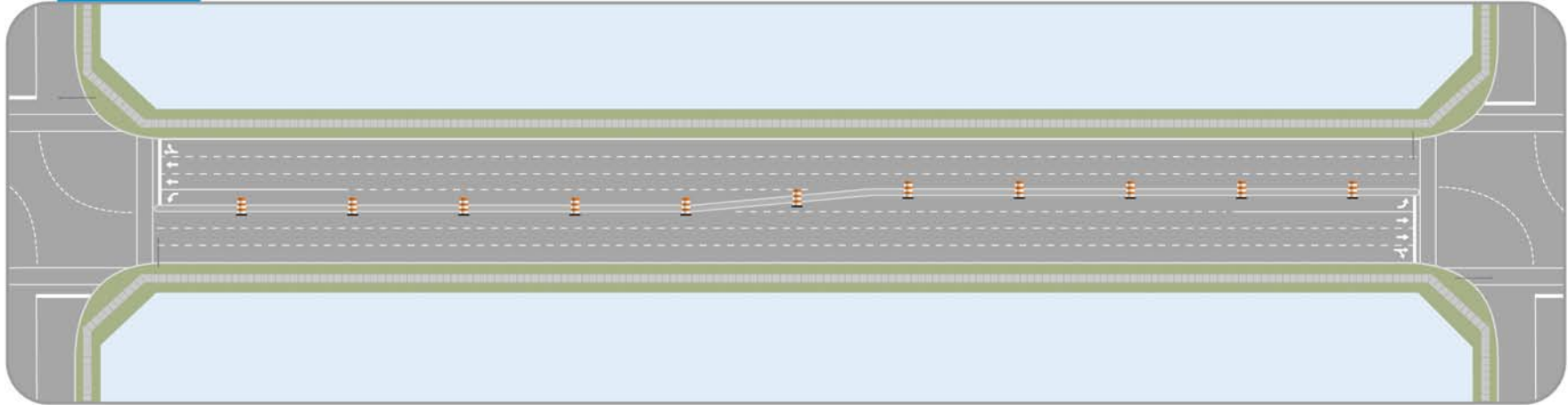

Stage 2 First side road widening

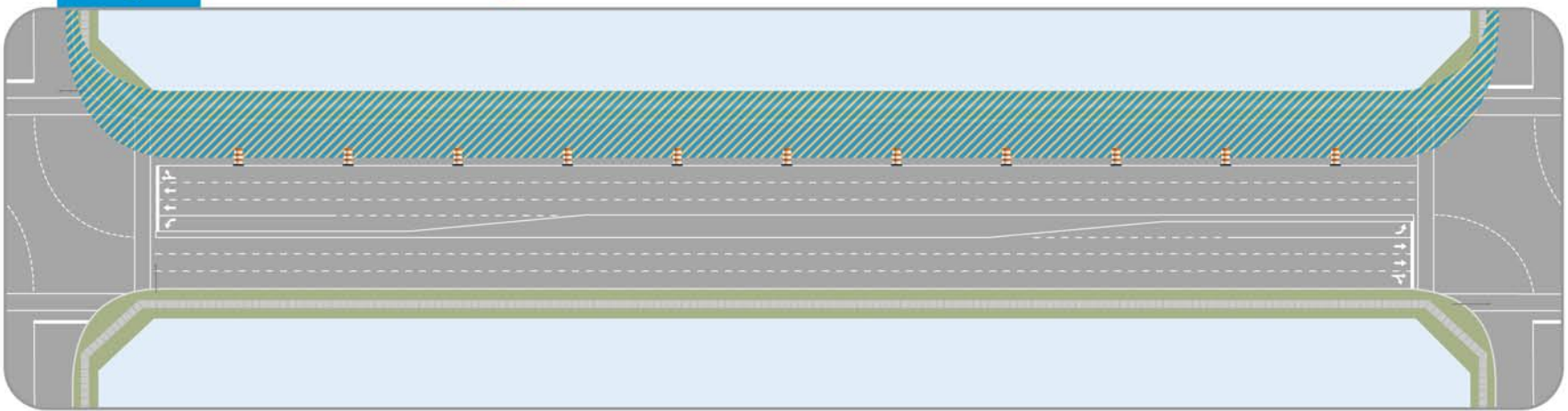

Stage 3 Second side road widening

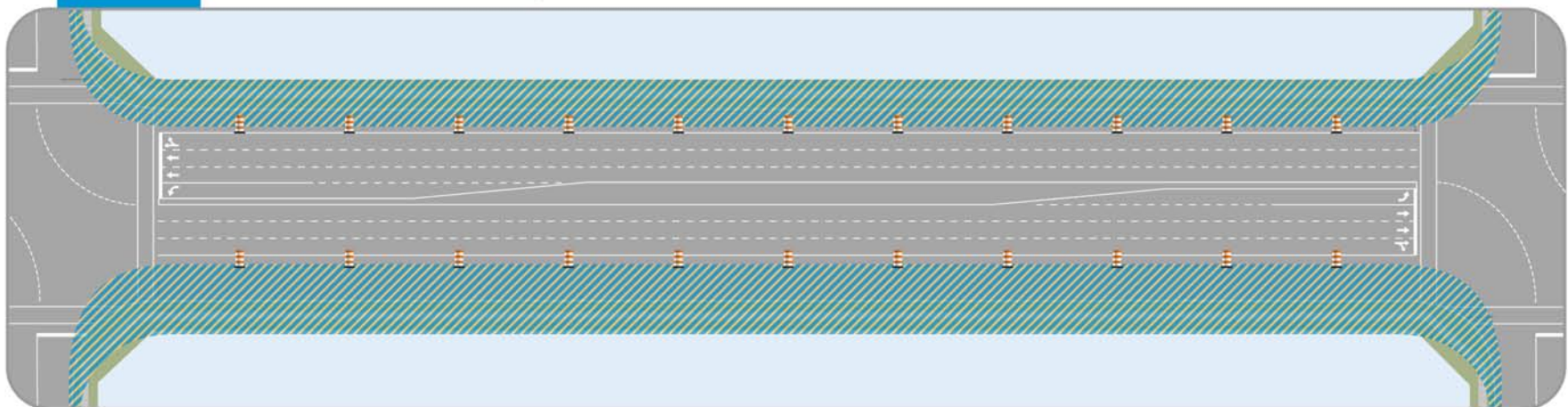

Stage 4 Platform and canopy installation

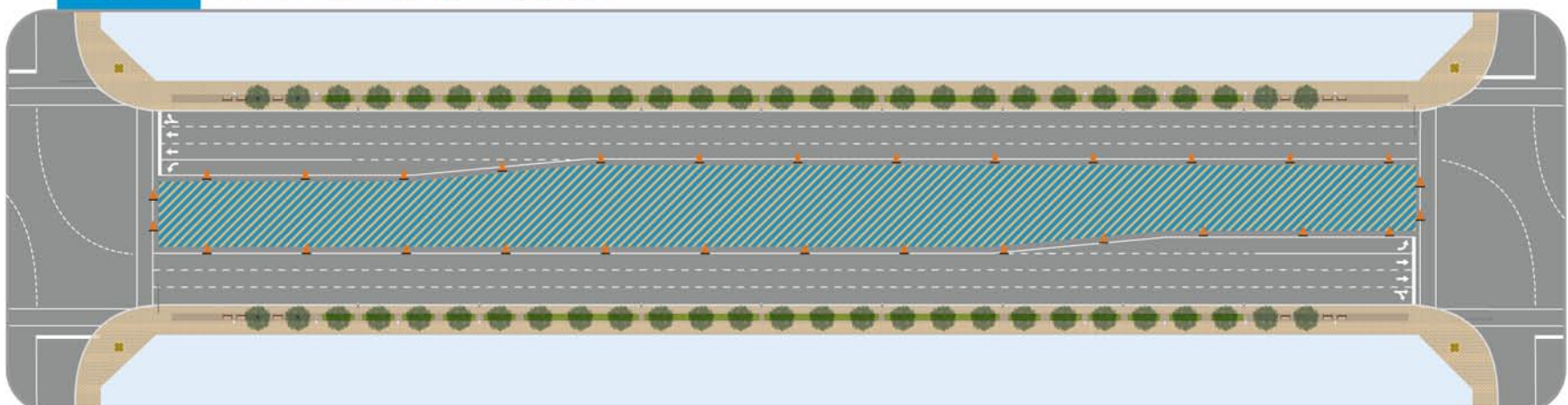

rapidway route and stations — bayview to warden



- > The first new rapidway station has been built and is in operation at the northeast corner of Enterprise Drive and Warden Avenue in Markham
- > There will be 11 additional vivastations built along Highway 7 East
- > These new stations will create a beautiful street presence with their airy glass canopies as growth continues to develop
- > Check out the future of rapid transit in York Region

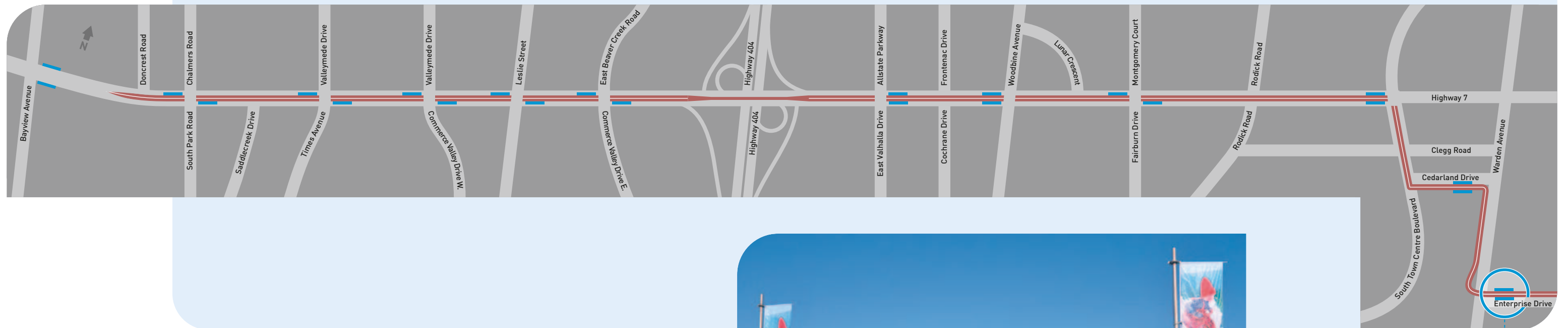

supporting local businesses throughout construction

> We are committed to minimizing construction impact on local businesses, by:

- Profiling local businesses on vivaNext website
- Ensuring customer access to businesses is maintained
- Providing open-for-business signage to encourage customer traffic
- Working with Chamber of Commerce and Board of Trade



keeping you informed throughout construction

- > Coping with construction is a lot easier when you know what to expect, where, and for how long
 - > It also helps to be reminded of all the great benefits you will enjoy at the end of it all
 - > Sign up for email updates at vivanext.com
- > You can readily find answers to any questions you may have through:
 - Regular project newsletters and bulletins
 - Your Community Liaison, Nimisha Raja
 - The vivaNext Project Information Centre opening Spring 2011
 - The vivaNext website and social media channels
 - Public open houses

