

TORONTO TRANSIT COMMISSION AND THE CITY OF TORONTO
NOTICE OF PREPARATION OF AN ADDENDUM REPORT
TO THE TORONTO-YORK SPADINA SUBWAY EXTENSION
Downsview Station to Steeles Avenue Individual Environmental Assessment (EA)

Change in Station Construction Methods and in the Horizontal and Vertical Alignment

The Toronto Transit Commission (TTC) and the City of Toronto are undertaking a study to amend the approved Environmental Assessment (EA) for the “Spadina Subway Extension – Downsview Station to Steeles Avenue” which was approved by the Minister of the Environment in October 2006. The amendment will study the environmental effects resulting from the:

- Change to the construction method from cut and cover construction to tunnelling for a distance of 425 \pm metres between Sheppard Avenue West and the Canadian National (CN) Rail right-of-way;
- Modifications to the vertical and horizontal alignment between Downsview Station and Keele Street;
- Lowering of the Sheppard West Station box by 8 \pm metres and relocating the station box 120 \pm metres east directly below the CN Rail right-of-way; and
- Integration of the design and construction of a GO Transit Rail station within the CN Rail right-of-way directly above and integrated with the relocated Sheppard West subway station.

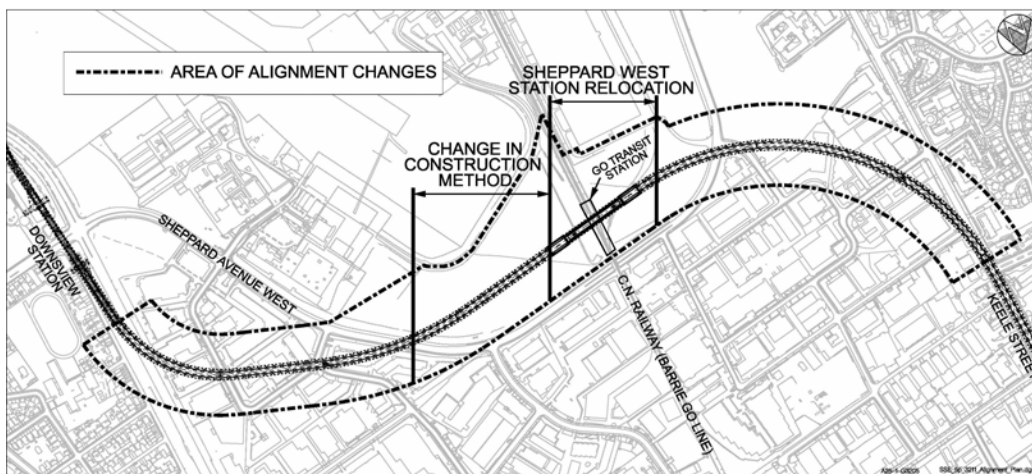

A change in construction method triggers the requirement to prepare an EA Addendum Report. The revised construction method will have scheduling and budgetary benefits and it is anticipated to result in reduced construction effects. All other changes, while within the amending boundaries of the approved EA, will result in changes to the environmental effects of the project.

The project is being assessed as an amendment to an Individual EA in accordance with the requirements in the Ontario *Environmental Assessment Act*. Input from members of the public is important. Upon completion of the Addendum Report, the document will be available to the public for comment. A notice will be published when the report is available for review.

For further information regarding the project or the addendum process, please contact the Toronto-York Spadina Subway Extension (TYSSE) at (416) 393-4001, via e-mail at TYSSE@ttc.ca (put

"Sheppard West EA" in the subject line), visit the website at: www.spadina.ttc.ca, or contact us at the address below.

Joanna Kervin, P. Eng.
Deputy Chief Project Manager
Third Party, Planning & Property
Toronto-York Spadina Subway Extension
5160 Yonge Street, Suite 1100
Toronto, Ontario, M2N 6L9

This notice was first issued on January 20, 2010.